

YOSHIMURA RACING TRI-OVAL STAINLESS 4-2-1-2 EXHAUST SYSTEM SUZUKI GSX-R1000K7-8



Stainless Sleeve ; 150-508-5352
Titanium Sleeve ; 150-508-5382
Carbon Sleeve ; 150-508-5392

Silencer Assy Left
156-508-535B Stainless Sleeve
156-508-538B Titanium Sleeve
156-508-539B Carbon Sleeve

Silencer Assy Right
156-508-5351 Stainless Sleeve
156-508-5381 Titanium Sleeve
156-508-5391 Carbon Sleeve

Silencer Band
162-39R-0015 for Stainless
& Titanium Sleeve
162-39R-0019 for Carbon Sleeve

Washer 8-26-1.6
812-108-2600

Cap Bolt M8x30
800-208-5030

Tailpipe Right
155-508-5000

Silencer Bracket Right
161-508-0200

Grommet Rubber
553-565-0000

Grommet Spacer
850-208-1212

Washer 8-26-1.6
812-108-2600

Washer (Copper)
812-318-0000

Plug
862-118-1500

Cap Bolt M8x15
800-208-5015

Flange Nut M8
823-008-1250

Washer 8-20-1.6
812-108-2000

Washer 8-26-1.6
812-108-2600

Cap Bolt M8x30
800-208-5030

Silencer Band Rubber
896-005-0135

Exhaust Spring
118-001-0000

Y Joint
142-508-5421

Lot Number

Grommet Rubber
553-565-0000

Silencer Bracket Left
161-508-1200

Grommet Spacer
850-208-1212

Washer 8-26-1.6
812-108-2600

Flange Nut M8
823-008-1250

Radiator Bracket
452-004-5080

Flange Nut M6
823-006-1000

Tailpipe Left
155-508-500A

Conical Spring Washer M8
811-108-0000

Y Joint Bracket
161-508-0001

Cap Bolt M8x25
800-208-5025

Washer 8-20-1.6
812-108-2000

Flange Nut M8
823-008-1250

Exhaust Spring
118-001-0000

Exhaust Spring
118-001-0000

Grommet Spacer (Small)
850-108-1010

Washer 8-20-1.6
812-108-2000

Grommet Rubber (Small)
875-308-0819

Drilled Cap Bolt M8x25
800-208-5S25

Collector Joint
119-508-5A00

Connector Pipe
142-045-2110

Flange
117-042-0100

Exhaust Spring
118-001-0000

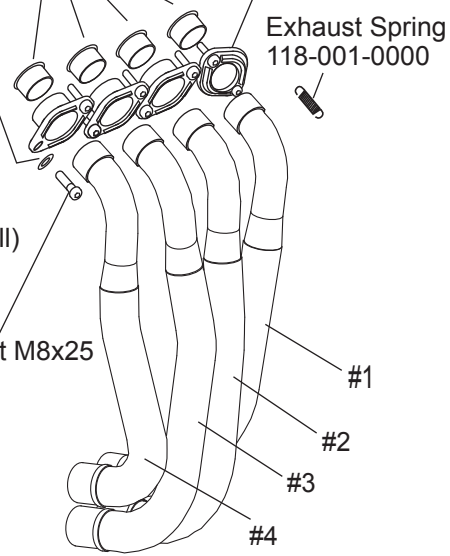

Exhaust Pipe #1 : 151-508-5900
Exhaust Pipe #2 : 152-508-5900
Exhaust Pipe #3 : 153-508-5900
Exhaust Pipe #4 : 154-508-5900