



SUZUKI GSX-R1000K9-L1/L2 STREET SPORTS TITANIUM / STAINLESS FULL SYSTEM R-11 DUAL EXIT

Be sure to read the instruction carefully before starting the work. It is necessary to follow the contents to install Yoshimura product.

⚠ DANGER

Installing on L2 model, EM Pro (P/N 490-519-0000) is required to install this exhaust system. In case that this system is installed with stock ECU, Exhaust Control Valve Canceler (P/N 194-519-0020) is required. If neglected, it may cause damage on Exhaust Control Valve Actuator.

1. Product Information:

Titanium Pipe Type

Description	Suzuki GSX-R1000K9-L1/L2 Street Sports Titanium Exhaust System R-11 Dual Exit
Cyclone Type	SP518T11C1
Main Materials	Titanium (exhaust pipes), Stainless Steel (Silencer Assy)
Part Number	Stainless Sleeve (TS) ; 180-518-8750
	Metal Magic Sleeve (TM) ; 180-518-8720
	Titanium Sleeve (TT) ; 180-518-8780
Weight ※1	(TS) ; 4.2kg / (TM) ; 4.2kg / (TT) ; 4.0kg

※1 STD weight : 8.0kg

※Part Number of additional lineup (Titanium Blue) : Add a letter "B" behind a Titanium item.
(e.g. Set : 180-xxx-xx8xB / Silencer Assy : 186-xxx-xx8xB)

Stainless Steel Pipe Type

Description	Suzuki GSX-R1000K9-L1/L2 Street Sports Stainless Exhaust System R-11 Dual Exit
Cyclone Type	SP518S11C1
Main Materials	Stainless Steel
Part Number	Stainless Sleeve (SS) ; 180-518-5750
	Metal Magic Sleeve (SM) ; 180-518-5720
	Titanium Sleeve (ST) ; 180-518-5780
Weight ※1	(SS) ; 5.8kg / (SM) ; 5.8kg / (ST) ; 5.6kg

2. Applicable Model:

Applicable Model	SUZUKI GSX-R1000K9-L1/L2
Type of Engine	T717

3. Required Parts for L2 model : One of below

EM Pro ; P/N 490-519-0000

Exhaust Control Valve Canceler ; P/N 194-519-0020

4. Contents:

No.	Descriptions	Part No.	Q'ty	No.	Descriptions	Part No.	Q'ty
Titanium Type				10	Cap Bolt M6x10	800-206-4010	1
1	Header Assy	151-519-8900	1	11	Conical Spring Washer M8	811-108-0000	8
2	Tailpipe	185-518-8700	1	12	Conical Spring Washer M6	810-206-0000	1
Stainless Type				13	Washer M8x26	812-108-2600	5
1	Header Assy	151-519-5900	1	14	Flange Nut M8	823-008-1250	2
2	Tailpipe	185-518-5700	1	15	Flange Nut M6	823-006-1000	1
3	Silencer Assy, Stainless Sleeve	186-518-5750	1	16	Grommet Rubber	553-565-0000	1
	Silencer Assy, Metal Magic Sleeve	186-518-5720		17	Grommet Spacer	850-208-1212	1
	Silencer Assy, Titanium Sleeve	186-518-5780		18	Spacer (Black) 8-26-10	850-008B2610	2
4	Silencer Bracket	161-518-0210	1	19	Exhaust Spring	118-001-0000	11
5	Flange	117-042-0100	4	20	A/F Sensor Boss Adapter	862-218-1210	1
6	Connector Pipe	142-045-3310	4	21	Washer (Copper)	812-318-0000	1
7	Drilled Cap Bolt M8x25	800-208-5S25	8	22	Radiator Bracket	452-004-5181	1
8	Cap Bolt M8x35	800-208-5035	1	23	Radiator-Oil Cooler Connecting	452-004-5182	1
9	Cap Bolt M8x45	800-208-5045	1	24	Bracket	452-004-5184	1

Parts Diagram

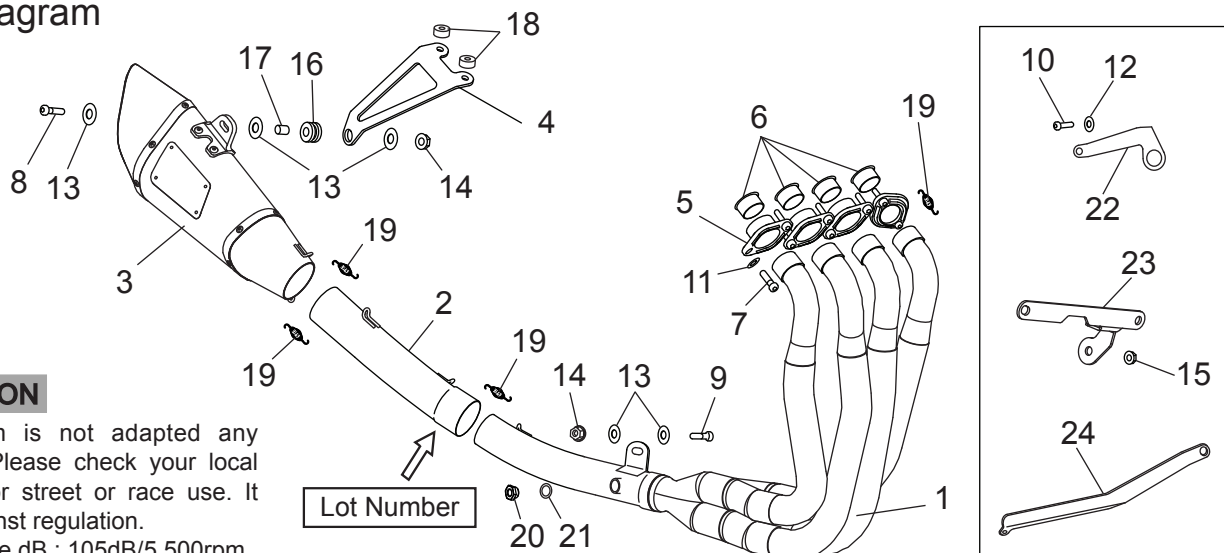

⚠ CAUTION

This system is not adapted any regulation. Please check your local regulation for street or race use. It may be against regulation.
Statistic noise dB ; 105dB/5,500rpm